

# L-SHAPED COUNTER

3' x 6' / 6' x 3'

Your kitchen layout and component totals depend on which edges of your counter either have a 4 cm finished edge or meet a wall/appliance. Edges are numbered in the image at right. All examples show standard 24" countertops with 90 degree installations.

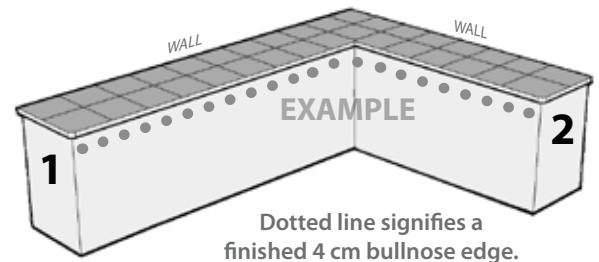

## STANDARD LAYOUT (NO EDGES 1 & 2)

Only front edges are finished; all others meet a wall.

OC <b>0</b>	BN <b>3</b>	ICL <b>1</b>	ICR <b>1</b>	FT <b>9</b>
OUTSIDE CORNER	BULL NOSE	INSIDE CORNER LEFT	INSIDE CORNER RIGHT	FIELD TILE

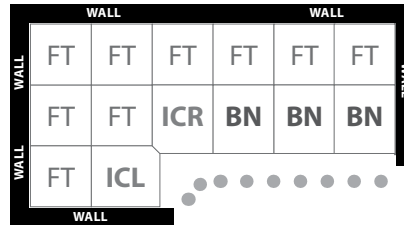

## EDGE 1 (OR EDGE 2) FINISHED

Edge 1 option is shown, but this layout can be used for Edge 2 as well by switching the corners.

OC <b>1</b>	BN <b>4</b>	ICL <b>0</b>	ICR <b>1</b>	FT <b>8</b>
OUTSIDE CORNER	BULL NOSE	INSIDE CORNER LEFT	INSIDE CORNER RIGHT	FIELD TILE

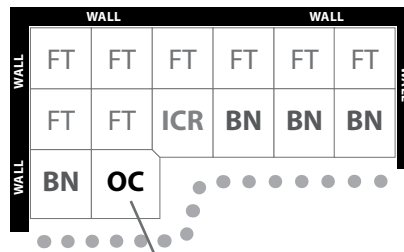

**NOTE:**  
This layout requires additional cutting of the Outside Corner piece.

## BOTH EDGES 1 & 2 FINISHED

Both Edges 1 and 2 are finished in this layout.

OC <b>2</b>	BN <b>4</b>	ICL <b>0</b>	ICR <b>1</b>	FT <b>7</b>
OUTSIDE CORNER	BULL NOSE	INSIDE CORNER LEFT	INSIDE CORNER RIGHT	FIELD TILE

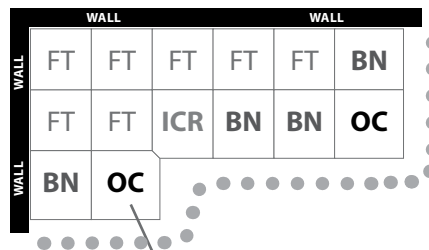

**NOTE:**  
This layout requires additional cutting of the Outside Corner piece.