

L-SHAPED COUNTER

6' x 6'

Your kitchen layout and component totals depend on which edges of your counter either have a 4 cm finished edge or meet a wall/appliance. Edges are numbered in the image at right. All examples show standard 24" countertops with 90 degree installations.

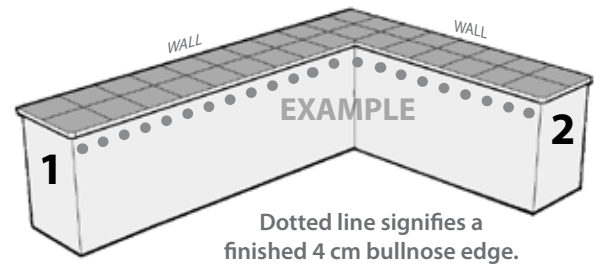

Dotted line signifies a finished 4 cm bullnose edge.

STANDARD LAYOUT (NO EDGES 1 & 2)

Only front edges are finished; all others meet a wall.

OC 0	BN 6	ICL 1	ICR 1	FT 12
OUTSIDE CORNER	BULL NOSE	INSIDE CORNER LEFT	INSIDE CORNER RIGHT	FIELD TILE

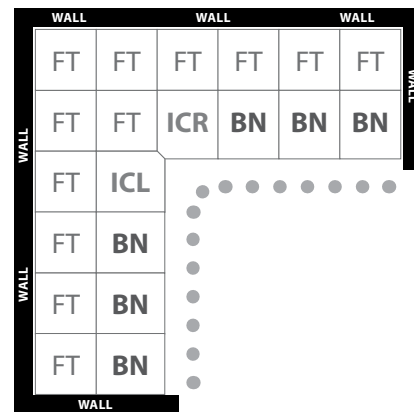

EDGE 1 (OR EDGE 2) FINISHED

Edge 1 option is shown, but this layout can be used for Edge 2 as well by switching the corners.

OC 1	BN 6	ICL 1	ICR 1	FT 11
OUTSIDE CORNER	BULL NOSE	INSIDE CORNER LEFT	INSIDE CORNER RIGHT	FIELD TILE

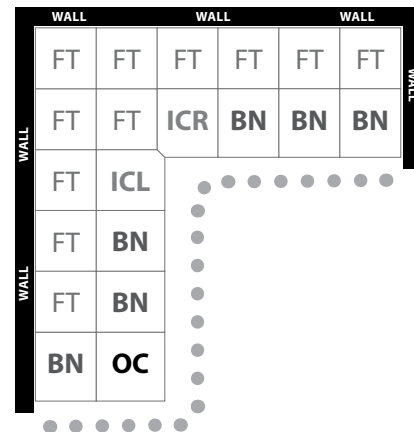

BOTH EDGES 1 & 2 FINISHED

Both Edges 1 and 2 are finished in this layout.

OC 2	BN 6	ICL 1	ICR 1	FT 10
OUTSIDE CORNER	BULL NOSE	INSIDE CORNER LEFT	INSIDE CORNER RIGHT	FIELD TILE

